



JOHN ENGLER  
GOVERNOR

STATE OF MICHIGAN  
DEPARTMENT OF ENVIRONMENTAL QUALITY  
SOUTHEAST MICHIGAN DISTRICT OFFICE



RUSSELL J. HARDING  
DIRECTOR

October 18, 2002

Burroughs Materials Company  
51445 West 12 Mile Road  
Wixom, MI 48393

ATTENTION: Mr. Ed Clements

Dear Mr. Clements:

SUBJECT: Wetland Assessment Report  
**Wetland Assessment File Number: 02-63-0028-WA**

The Department of Environmental Quality (DEQ) conducted on September 19, 2002, a Level 3 Wetland Assessment on property (property tax identification number 06-24-400-004) located in Town 04N, Range 07E, Section 24, within Rose Township, Oakland County. The assessment was conducted in accordance with Part 303, Wetland Protection of the Natural Resources and Environmental Protection Act, 1994 PA 451, as amended (NREPA); and Rule 4, Wetland Assessments (R 281.924) of the Administrative Rules for Part 303. This is a report of our findings in response to your wetland assessment application.

The DEQ staff observed all of the flagged boundaries with your consultant Woody Held of King and MacGregor Environmental, Inc, as requested in your wetland assessment application. Based on our on-site investigation, which included review of plant communities, hydrologic indicators, and soils of the assessment area, and an in-office review of other pertinent information, **the DEQ finds the subject parcel contains state-regulated wetlands and a state-regulated lake.** The DEQ is in agreement with all boundaries as flagged. Enclosed is a site map of the assessment area that was created by combining information from your consultant and the DEQ. This map identifies all state-regulated wetlands, one state regulated lake, non state-regulated wetlands, and non regulated upland areas within the assessment area.

**The areas below have been identified as state-regulated wetland, or as a state-regulated lake on the site map.**

1. Wetlands AA, AC, BB, B, CC, D, EE, E, FF, F, GG, G, HH, H, II, K, L, LE, V.
2. One State-regulated lake consisting of 9.15 acres.

RECEIVED  
OCT 23 2002

October 18, 2002

Your assessment area does not appear to be within those areas also regulated by the USACE. However, should you desire more information, please contact the USACE at 313-226-2218.

This assessment report is limited to findings pursuant to Part 303 and does not constitute a determination of jurisdiction under other DEQ administered programs. Any land use activities undertaken on the assessed parcel may be subject to regulation pursuant to the NREPA under the following programs:

Floodplain Regulatory Authority found in Part 31, Water Resources Protection  
Part 91, Soil Erosion and Sedimentation Control  
Part 301, Inland Lakes and Streams

The findings contained in this report do not convey, provide, or otherwise imply approval of any governing act, ordinance, or regulation, nor does it waive the obligation to acquire any applicable state, county, local, or federal approval or authorizations necessary to conduct any possible activities. This assessment report is not a permit for any activity that requires a permit from the DEQ.

The findings contained in this report are binding on the DEQ until September 19, 2005, a period of three years from the date of the assessment unless a reassessment is conducted. Please contact me if you have any questions regarding this assessment report.

Sincerely,



Mary Vanderlaan  
District Supervisor  
Geological and Land Management Division  
734-953-1465

Enclosures

cc: Mr. Woody Held, King and MacGregor Environmental, Inc.,  
Ms. Wendy Veltman, DEQ  
Mr. Todd Losee, DEQ



# Location Map Burroughs Materials - Ormond Rd.

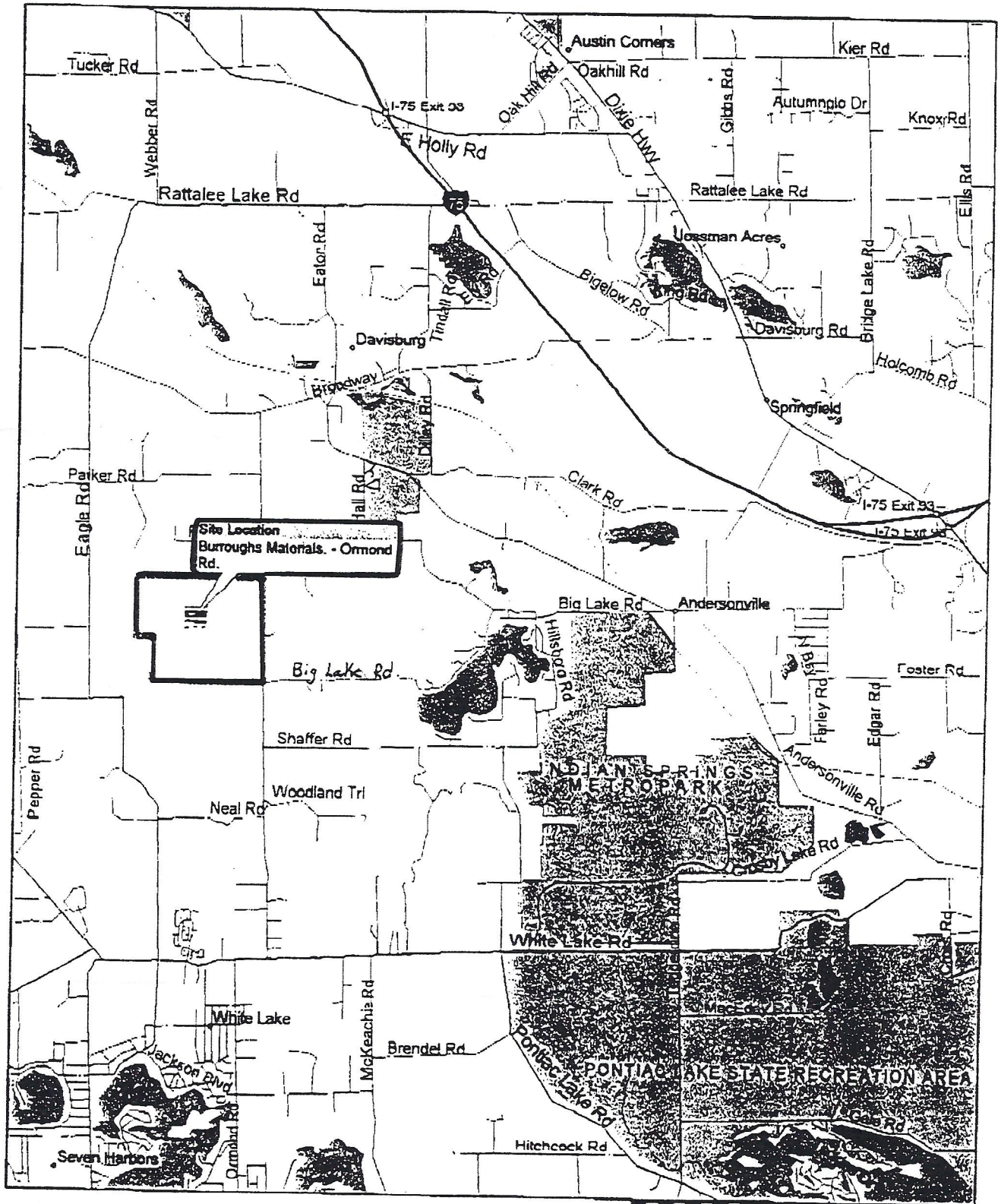

Site  
 Burroughs Materials Company  
 File 02-63-0028-WA  
 September 19, 2002  
 482.0 Acres

**Burroughs Materials Company**  
 File 02-63-0028-WA  
 September 19, 2002

- Legend**
- = Wetland State-Regulated
  - = State-Regulated Lake
  - = Non-Regulated Wetland
  - UPL = Upland (Non Wetland)
- Scale = 1" = 700 Feet

Map compiled from information provided by the Burroughs File (02-63-0028-WA) and Wetland Assessment Data collected on September 19, 2002

This drawing showing those areas containing wetland and not containing wetland is an approximation of the boundaries on site

Wetland boundaries should be surveyed to reflect a true representation

of wetland and upland on site. This drawing does not authorize or permit activities

requiring a permit in accordance with Part 303 of the Natural Resources and

Environmental Protection Act, 1994 PA 451, as amended.





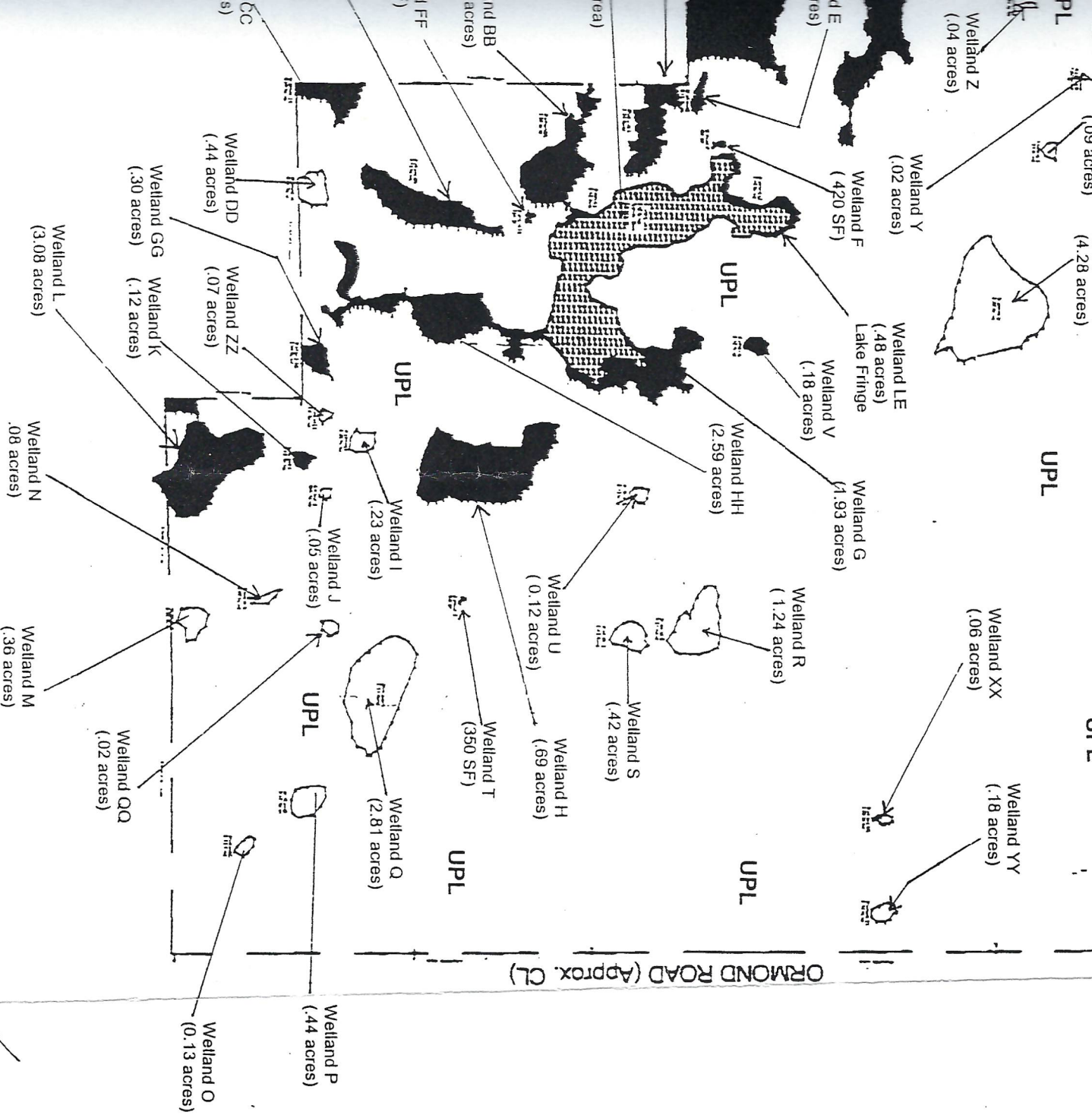

*Mark V. Baker*  
9-19-2002